

KUMW-4

超硬裏面取りカッター 両角タイプ
Tungsten Carbide Chamfering Cutter Single Angular type

■直刃4枚刃、90°（両角）の両面取りカッターです
Straight 4-blade, 90° (double-edged) double-sided cutter

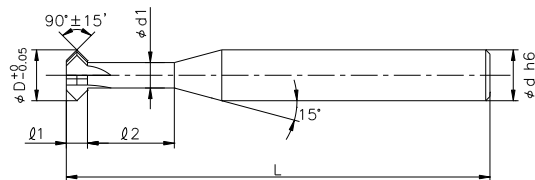
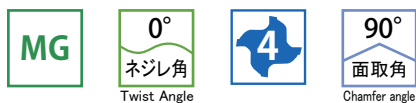

被削材 Workpiece					
一般構造鋼 General Structural Steel	炭素鋼 Carbon Steel	合金鋼・工具鋼 Alloy Steel Tool Steel	プリハードン鋼 Pre-Harden Steel	鋳鉄 Cast Iron	アルミ合金 Aluminum Alloy
○	○	○	○	○	○

●切削条件表はP226に記載
●Cutting conditions are recommended on page 226.

単位[寸法:mm/価格:円]
Unit [size:mm/Retail Price:JPY]

品番 Code No.	外径 D Flute Diameter	有効長 ℓ2 Effective Length	刃長 ℓ1 Flute Length	首径 d1 Neck Diameter	全長 L Total Length	柄径 d Shank Diameter	標準価格 Retail Price
KUMW-490010S	1	3	0.25	0.65	50	4	13,200
KUMW-490010L	1	6	0.25	0.65	50	4	14,500
KUMW-490011S	1.1	3	0.3	0.7	50	4	13,200
KUMW-490011L	1.1	6	0.3	0.7	50	4	14,500
KUMW-490012S	1.2	3	0.35	0.75	50	4	13,200
KUMW-490012L	1.2	6	0.35	0.75	50	4	14,500
KUMW-490013S	1.3	3	0.4	0.8	50	4	13,200
KUMW-490013L	1.3	6	0.4	0.8	50	4	14,500
KUMW-490014S	1.4	3	0.4	0.9	50	4	13,200
KUMW-490014L	1.4	6	0.4	0.9	50	4	14,500
KUMW-490015S	1.5	4	0.4	1	50	4	12,500
KUMW-490015L	1.5	8	0.4	1	50	4	13,700
KUMW-490016S	1.6	4	0.5	1	50	4	12,500
KUMW-490016L	1.6	8	0.5	1	50	4	13,700
KUMW-490017S	1.7	4	0.6	1	50	4	12,500
KUMW-490017L	1.7	8	0.6	1	50	4	13,700
KUMW-490018S	1.8	4	0.6	1.1	50	4	12,500
KUMW-490018L	1.8	8	0.6	1.1	50	4	13,700
KUMW-490019S	1.9	4	0.6	1.2	50	4	12,500
KUMW-490019L	1.9	8	0.6	1.2	50	4	13,700
KUMW-490020S	2	5	0.8	1.1	50	4	12,500
KUMW-490020L	2	10	0.8	1.1	50	4	13,700
KUMW-490021S	2.1	5	0.8	1.2	50	4	12,500
KUMW-490021L	2.1	10	0.8	1.2	50	4	13,700
KUMW-490022S	2.2	5	0.8	1.3	50	4	12,500
KUMW-490022L	2.2	10	0.8	1.3	50	4	13,700
KUMW-490023S	2.3	5	0.8	1.4	50	4	12,500
KUMW-490023L	2.3	10	0.8	1.4	50	4	13,700
KUMW-490024S	2.4	5	0.8	1.5	50	4	12,500
KUMW-490024L	2.4	10	0.8	1.5	50	4	13,700

品番 Code No.	外径 D Flute Diameter	有効長 ℓ2 Effective Length	刃長 ℓ1 Flute Length	首径 d1 Neck Diameter	全長 L Total Length	柄径 d Shank Diameter	標準価格 Retail Price
KUMW-490025S	2.5	6	1	1.4	50	4	12,500
KUMW-490025L	2.5	12	1	1.4	50	4	13,700
KUMW-490026S	2.6	6	1	1.5	50	4	12,500
KUMW-490026L	2.6	12	1	1.5	50	4	13,700
KUMW-490027S	2.7	6	1	1.6	50	4	12,500
KUMW-490027L	2.7	12	1	1.6	50	4	13,700
KUMW-490028S	2.8	6	1	1.7	50	4	12,500
KUMW-490028L	2.8	12	1	1.7	50	4	13,700
KUMW-490029S	2.9	6	1	1.8	50	4	12,500
KUMW-490029L	2.9	12	1	1.8	50	4	13,700
KUMW-490030S	3	8	1.2	1.7	50	4	13,700
KUMW-490030L	3	16	1.2	1.7	50	4	14,800
KUMW-490031S	3.1	8	1.2	1.8	50	4	13,700
KUMW-490031L	3.1	16	1.2	1.8	50	4	14,800
KUMW-490032S	3.2	8	1.2	1.9	50	4	13,700
KUMW-490032L	3.2	16	1.2	1.9	50	4	14,800
KUMW-490033S	3.3	8	1.2	2	50	4	13,700
KUMW-490033L	3.3	16	1.2	2	50	4	14,800
KUMW-490034S	3.4	8	1.2	2.1	50	4	13,700
KUMW-490034L	3.4	16	1.2	2.1	50	4	14,800
KUMW-490035S	3.5	9	1.4	2	50	4	13,700
KUMW-490035L	3.5	18	1.4	2	50	4	14,800
KUMW-490036S	3.6	9	1.4	2.1	50	4	13,700
KUMW-490036L	3.6	18	1.4	2.1	50	4	14,800
KUMW-490037S	3.7	9	1.4	2.2	50	4	13,700
KUMW-490037L	3.7	18	1.4	2.2	50	4	14,800
KUMW-490038S	3.8	9	1.4	2.3	50	4	13,700
KUMW-490038L	3.8	18	1.4	2.3	50	4	14,800
KUMW-490039S	3.9	9	1.4	2.4	50	4	13,700
KUMW-490039L	3.9	18	1.4	2.4	50	4	14,800

KUMC-4、KUMW-4

切削条件参考

Referential Cutting Conditions

被削材 Workpiece	切削速度 Cutting Speed m/min	送り速度 Feed mm/rev
炭素工具鋼 Carbon Tool Steel	30～ 60	0.05 ～0.12
鋳鉄 Cast Iron	30～ 80	0.05 ～0.12
合金鋼 Alloy Steel	25～ 70	0.03 ～0.08
プリハードン鋼 Pre-Harden Steel	15～ 40	0.02 ～0.06
ステンレス Stainless Steel	20～ 50	0.025～0.06
銅・銅合金 Copper and Copper Alloy	25～ 80	0.05 ～0.1
チタン合金 Titanium Alloy	15～ 30	0.02 ～0.05
アルミ合金 Aluminum Alloy	50～100	0.05 ～0.15
樹脂 Resin	50～120	0.1 ～0.2
備考 Remarks	<ul style="list-style-type: none"> 加工形状により切削速度、送り速度を調整して下さい。 Adjust Revolution and Feed Speed at the same rate. 	