

KUMC-4

超硬裏面取りカッター 片角タイプ Tungsten Carbide Chamfering Cutter Single Angular type

- 直刃4枚刃、45°(片角)の裏面取りカッターです
Straight 4-blade, 45° (one-angle) back-surface cutter
- 底刃付のため、溝加工も可能です
With a bottom blade, grooving is also possible

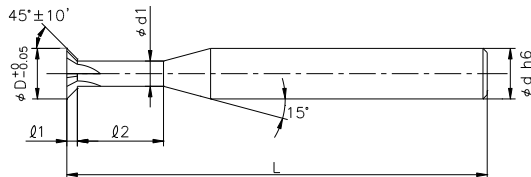

被削材 Workpiece					
一般構造鋼 General Structural Steel	炭素鋼 Carbon Steel	合金鋼・工具鋼 Alloy Steel Tool Steel	プリハードン鋼 Pre-Harden Steel	鋳鉄 Cast Iron	アルミ合金 Aluminum Alloy
○	○	○	○	○	○

●切削条件表はP226に記載

●Cutting conditions are recommended on page 226.

単位[寸法:mm/価格:円]
Unit [size:mm/Retail Price:JPY]

品番 Code No.	外径 D Flute Diameter	有効長 ℓ2 Effective Length	刃長 ℓ1 Flute Length	首径 d1 Neck Diameter	全長 L Total Length	柄径 d Shank Diameter	標準価格 Retail Price
KUMC-445010S	1	3	0.12	0.65	50	4	13,200
KUMC-445010L	1	6	0.12	0.65	50	4	14,500
KUMC-445011S	1.1	3	0.15	0.7	50	4	13,200
KUMC-445011L	1.1	6	0.15	0.7	50	4	14,500
KUMC-445012S	1.2	3	0.17	0.75	50	4	13,200
KUMC-445012L	1.2	6	0.17	0.75	50	4	14,500
KUMC-445013S	1.3	3	0.2	0.8	50	4	13,200
KUMC-445013L	1.3	6	0.2	0.8	50	4	14,500
KUMC-445014S	1.4	3	0.2	0.9	50	4	13,200
KUMC-445014L	1.4	6	0.2	0.9	50	4	14,500
KUMC-445015S	1.5	4	0.2	1	50	4	12,500
KUMC-445015L	1.5	8	0.2	1	50	4	13,700
KUMC-445016S	1.6	4	0.25	1	50	4	12,500
KUMC-445016L	1.6	8	0.25	1	50	4	13,700
KUMC-445017S	1.7	4	0.3	1	50	4	12,500
KUMC-445017L	1.7	8	0.3	1	50	4	13,700
KUMC-445018S	1.8	4	0.3	1.1	50	4	12,500
KUMC-445018L	1.8	8	0.3	1.1	50	4	13,700
KUMC-445019S	1.9	4	0.3	1.2	50	4	12,500
KUMC-445019L	1.9	8	0.3	1.2	50	4	13,700
KUMC-445020S	2	5	0.4	1.1	50	4	12,500
KUMC-445020L	2	10	0.4	1.1	50	4	13,700
KUMC-445021S	2.1	5	0.4	1.2	50	4	12,500
KUMC-445021L	2.1	10	0.4	1.2	50	4	13,700
KUMC-445022S	2.2	5	0.4	1.3	50	4	12,500
KUMC-445022L	2.2	10	0.4	1.3	50	4	13,700
KUMC-445023S	2.3	5	0.4	1.4	50	4	12,500
KUMC-445023L	2.3	10	0.4	1.4	50	4	13,700
KUMC-445024S	2.4	5	0.4	1.5	50	4	12,500
KUMC-445024L	2.4	10	0.4	1.5	50	4	13,700

品番 Code No.	外径 D Flute Diameter	有効長 ℓ2 Effective Length	刃長 ℓ1 Flute Length	首径 d1 Neck Diameter	全長 L Total Length	柄径 d Shank Diameter	標準価格 Retail Price
KUMC-445025S	2.5	6	0.5	1.4	50	4	12,500
KUMC-445025L	2.5	12	0.5	1.4	50	4	13,700
KUMC-445026S	2.6	6	0.5	1.5	50	4	12,500
KUMC-445026L	2.6	12	0.5	1.5	50	4	13,700
KUMC-445027S	2.7	6	0.5	1.6	50	4	12,500
KUMC-445027L	2.7	12	0.5	1.6	50	4	13,700
KUMC-445028S	2.8	6	0.5	1.7	50	4	12,500
KUMC-445028L	2.8	12	0.5	1.7	50	4	13,700
KUMC-445029S	2.9	6	0.5	1.8	50	4	12,500
KUMC-445029L	2.9	12	0.5	1.8	50	4	13,700
KUMC-445030S	3	8	0.6	1.7	50	4	13,700
KUMC-445030L	3	16	0.6	1.7	50	4	14,800
KUMC-445031S	3.1	8	0.6	1.8	50	4	13,700
KUMC-445031L	3.1	16	0.6	1.8	50	4	14,800
KUMC-445032S	3.2	8	0.6	1.9	50	4	13,700
KUMC-445032L	3.2	16	0.6	1.9	50	4	14,800
KUMC-445033S	3.3	8	0.6	2	50	4	13,700
KUMC-445033L	3.3	16	0.6	2	50	4	14,800
KUMC-445034S	3.4	8	0.6	2.1	50	4	13,700
KUMC-445034L	3.4	16	0.6	2.1	50	4	14,800
KUMC-445035S	3.5	9	0.7	2	50	4	13,700
KUMC-445035L	3.5	18	0.7	2	50	4	14,800
KUMC-445036S	3.6	9	0.7	2.1	50	4	13,700
KUMC-445036L	3.6	18	0.7	2.1	50	4	14,800
KUMC-445037S	3.7	9	0.7	2.2	50	4	13,700
KUMC-445037L	3.7	18	0.7	2.2	50	4	14,800
KUMC-445038S	3.8	9	0.7	2.3	50	4	13,700
KUMC-445038L	3.8	18	0.7	2.3	50	4	14,800
KUMC-445039S	3.9	9	0.7	2.4	50	4	13,700
KUMC-445039L	3.9	18	0.7	2.4	50	4	14,800

KUMC-4、KUMW-4

切削条件参考

Referential Cutting Conditions

被削材 Workpiece	切削速度 Cutting Speed m/min	送り速度 Feed mm/rev
炭素工具鋼 Carbon Tool Steel	30～ 60	0.05 ～0.12
鑄 鉄 Cast Iron	30～ 80	0.05 ～0.12
合 金 鋼 Alloy Steel	25～ 70	0.03 ～0.08
プリハードン鋼 Pre-Harden Steel	15～ 40	0.02 ～0.06
ステンレス Stainless Steel	20～ 50	0.025～0.06
銅・銅合金 Copper and Copper Alloy	25～ 80	0.05 ～0.1
チタン合金 Titanium Alloy	15～ 30	0.02 ～0.05
アルミ合金 Aluminum Alloy	50～100	0.05 ～0.15
樹 脂 Resin	50～120	0.1 ～0.2
備 考 Remarks	<ul style="list-style-type: none"> 加工形状により切削速度、送り速度を調整して下さい。 Adjust Revolution and Feed Speed at the same rate. 	