

# DCHBD-2

超硬ルーマ型ドリル・DIAコーティング付（硬脆材加工用）  
Tungsten Carbide 2 Flutes Micro Drill DIA Coating (For Processing Hard Brittle Material)

■硬脆材向けにDIAコーティングを施しました  
DIA coating for hard brittle material

**K10**

**30°**  
ネジレ角  
Twist Angle

**2**

**130°**  
先端角  
Point Angle

**DIA**

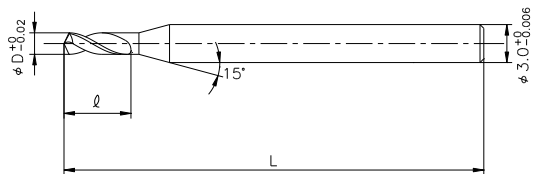

単位[寸法:mm/価格:円]  
Unit [size:mm/Retail Price:J.P.Y]

|                         |
|-------------------------|
| 被削材 Workpiece           |
| 硬脆材<br>Brittle material |
| ◎                       |

| 品番<br>Code No. | 刃径 D<br>Flute Diameter | 溝長 $l$<br>Groove length | 全長 L<br>Total Length | 柄径<br>Shank Diameter | 標準価格<br>Retail Price |
|----------------|------------------------|-------------------------|----------------------|----------------------|----------------------|
| DCHBD-2010     | 0.1                    | 1.2                     | 38                   | 3                    | 27,000               |
| DCHBD-2011     | 0.11                   | 1.2                     | 38                   | 3                    | 27,000               |
| DCHBD-2012     | 0.12                   | 1.4                     | 38                   | 3                    | 26,000               |
| DCHBD-2013     | 0.13                   | 1.4                     | 38                   | 3                    | 26,000               |
| DCHBD-2014     | 0.14                   | 1.4                     | 38                   | 3                    | 26,000               |
| DCHBD-2015     | 0.15                   | 1.8                     | 38                   | 3                    | 26,000               |
| DCHBD-2016     | 0.16                   | 1.8                     | 38                   | 3                    | 26,000               |
| DCHBD-2017     | 0.17                   | 1.8                     | 38                   | 3                    | 26,000               |
| DCHBD-2018     | 0.18                   | 2.1                     | 38                   | 3                    | 25,000               |
| DCHBD-2019     | 0.19                   | 2.1                     | 38                   | 3                    | 25,000               |
| DCHBD-2020     | 0.2                    | 2.4                     | 38                   | 3                    | 24,000               |
| DCHBD-2021     | 0.21                   | 2.4                     | 38                   | 3                    | 24,000               |
| DCHBD-2022     | 0.22                   | 2.6                     | 38                   | 3                    | 24,000               |
| DCHBD-2023     | 0.23                   | 2.6                     | 38                   | 3                    | 24,000               |
| DCHBD-2024     | 0.24                   | 2.6                     | 38                   | 3                    | 24,000               |
| DCHBD-2025     | 0.25                   | 3                       | 38                   | 3                    | 23,000               |
| DCHBD-2026     | 0.26                   | 3                       | 38                   | 3                    | 23,000               |
| DCHBD-2027     | 0.27                   | 3                       | 38                   | 3                    | 23,000               |
| DCHBD-2028     | 0.28                   | 3.3                     | 38                   | 3                    | 23,000               |
| DCHBD-2029     | 0.29                   | 3.3                     | 38                   | 3                    | 23,000               |
| DCHBD-2030     | 0.3                    | 5                       | 38                   | 3                    | 21,500               |
| DCHBD-2035     | 0.35                   | 5                       | 38                   | 3                    | 21,500               |
| DCHBD-2040     | 0.4                    | 6                       | 38                   | 3                    | 21,500               |
| DCHBD-2045     | 0.45                   | 6                       | 38                   | 3                    | 21,500               |
| DCHBD-2050     | 0.5                    | 6                       | 38                   | 3                    | 21,500               |
| DCHBD-2055     | 0.55                   | 6                       | 38                   | 3                    | 21,500               |
| DCHBD-2060     | 0.6                    | 7                       | 38                   | 3                    | 21,500               |
| DCHBD-2065     | 0.65                   | 7                       | 38                   | 3                    | 21,500               |
| DCHBD-2070     | 0.7                    | 8                       | 38                   | 3                    | 21,500               |
| DCHBD-2075     | 0.75                   | 8                       | 38                   | 3                    | 21,500               |

| 品番<br>Code No. | 刃径 D<br>Flute Diameter | 溝長 $l$<br>Groove length | 全長 L<br>Total Length | 柄径<br>Shank Diameter | 標準価格<br>Retail Price |
|----------------|------------------------|-------------------------|----------------------|----------------------|----------------------|
| DCHBD-2080     | 0.8                    | 8                       | 38                   | 3                    | 21,500               |
| DCHBD-2085     | 0.85                   | 8                       | 38                   | 3                    | 21,500               |
| DCHBD-2090     | 0.9                    | 8                       | 38                   | 3                    | 21,500               |
| DCHBD-2095     | 0.95                   | 8                       | 38                   | 3                    | 21,500               |
| DCHBD-2100     | 1                      | 10                      | 38                   | 3                    | 21,500               |
|                |                        |                         |                      |                      |                      |
|                |                        |                         |                      |                      |                      |
|                |                        |                         |                      |                      |                      |
|                |                        |                         |                      |                      |                      |
|                |                        |                         |                      |                      |                      |
|                |                        |                         |                      |                      |                      |
|                |                        |                         |                      |                      |                      |
|                |                        |                         |                      |                      |                      |
|                |                        |                         |                      |                      |                      |
|                |                        |                         |                      |                      |                      |
|                |                        |                         |                      |                      |                      |
|                |                        |                         |                      |                      |                      |
|                |                        |                         |                      |                      |                      |
|                |                        |                         |                      |                      |                      |
|                |                        |                         |                      |                      |                      |
|                |                        |                         |                      |                      |                      |
|                |                        |                         |                      |                      |                      |
|                |                        |                         |                      |                      |                      |
|                |                        |                         |                      |                      |                      |
|                |                        |                         |                      |                      |                      |
|                |                        |                         |                      |                      |                      |
|                |                        |                         |                      |                      |                      |